

# ENC X-Y-Z table screwing machine (Blowing screw type)

High quality precision electric screwdriver + Successful screw feeding can reach 99.9%

+ Large capacity + Smart brain + X-Y-Z table model = Perfect function in your work



## Features:

- 1) Adopt the high quality electric and pneumatic screwdriver especial for automation, or motor, improve machine stable.
- 2) The screw receiver nose can be designed base your screw, it can ensure the smooth and stable operation. Of course, it can supply you a perfect experience of screw assembly.
- 3) Our X-Y-Z table model is equipped with step motor/servo motor, so the accuracy of round trip can reach  $\pm 0.04\text{mm}$ .
- 4) Big movement range in X, Y, Z direction, The Max. movement range is 500mm, Of course, if your requirement is more than 500mm, then we can custom the model "ENC-D series" for you.
- 5) The X-Y-Z table model is the standard product, so it allows short delivering time and stable function.
- 6) Huge screw feeder, it can hold 2000~10000 pieces screw. So you should never need to worry about the screw feeding.
- 7) The machine owns an intelligent brain, it can offer many special function as the following: Quantity statistics (OK amount and NG amount), thread slip detection, floating detection, screw omission detection and so on.

## Suitable screw:

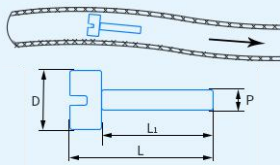

### Condition:

$L \geq D + 2\text{mm}$ ;  $M \geq 1\text{mm}$ ;  $L1 \leq 30\text{mm}$

### NOTE:

If your screw can not meet this condition, please refer p39 and P40.

## Reference images:

One sliding table type



ENC-300

Two fastening spindles type



ENC-400D

ENC-D series



ENC-D series

## Specification:

Suffix "D" (Double sliding tables in the Y axis direction)

Item/Model	ENC-300	ENC-400	ENC-500	ENC-400D	ENC-500D	ENC-D series
Working range (mm)	300x300x100	400x400x100	500x500x100	400x300x100	500x300x100	X/Y:200~1000
Max load Y/Z	5kg/3kg	10kg/5kg				15kg/15kg
Moving speed (mm/Sec.)	0.1~500/250		0.1~800/500		0.1~1000	
Program record volume	4000 points per group, at least 100 group; D series support U disk copy					
Data storage type	CF card				CF Card & PLC	
Program display	Chinese/English LED display					
Motor system	Micro-step precision motor					Servo motor
Position accuracy (mm)	0.02/Axis					0.01/Axis
Round position accuracy (mm)	$\pm 0.02$ /Axis					$\pm 0.01$ /Axis
Operation Mode	PTP & CP					
Interpolation Function	3 Axis					
Edit mode	Teach Pendant / HMI					HMI
I/O Signal port	8 Inputs/Outputs					16 Inputs/Outputs
Power supply	110~240ACV, 50/60Hz					
Working temperature (°C)	-10~40					
Working humidity	20~90% no condensation					
Dimension (mm)	620x580x620	720x680x620	820x780x620	820x580x620	920x580x620	Customization
Net weight (kg)	60	65	70	80	85	/

## Application area:

Home electronic appliances, electronic products, meters, toys, power supply, furniture, LED, communication product, computer keyboard PC, mobile phone, TV, and so on.

# ENC X-Y-Z table screwing machine (Vacuum suction type)

Meet screws in different texture + Special for screws in Mini or small size  
+ Successful screw feeding can reach 99.9% = Perfect function in your work



## Features:

- 1) Adopt the high quality electric and pneumatic screwdriver especial for automation, or motor, improve machine stable.
- 2) The sucker is designed base on your screw and actual condition around the screw holes of your product sample, so the success rate of screw feeding can reach 99.9%.
- 3) Our X-Y-Z table model is equipped with step motor/servo motor, so the accuracy of round trip can reach  $\pm 0.04$ mm.
- 4) Big movement range in X, Y, Z direction, The Max. movement range is 500mm, Of course, if your requirement is more than 500mm, then we can custom the model "ENC-D series" for you.
- 5) The X-Y-Z table model is the standard product, so it allows short delivering time and stable function.
- 6) Because adopt the vacuum sucker to pick up screws, so it can meet all kinds screw in different texture.
- 7) The machine owns an intelligent brain, it can offer many special function as the following: Quantity statistics (OK amount and NG amount), thread slip detection, floating detection, screw omission detection and so on.
- 8) What's more important, this kind machine is suitable for assembling the product sample with the Mini or small screw much.

## Reference image:

Two sliding tables type



ENC-V400D



Enlarged view

## Applicable screws type:

Mini. size	Plastic	Copper
Aluminous	With washer	Short thread

**NOTE:**  
① The total length must be less than 15mm.  
② The groove must be cross or slot.

## Working steps:

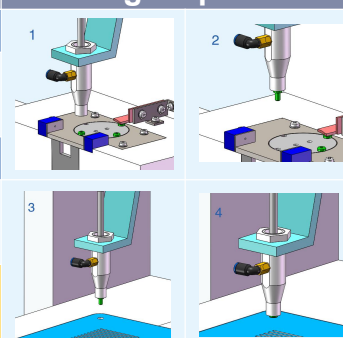

## Specification:

Suffix "D" (Double sliding tables in the Y axis direction)

Item/Model	ENC-V300	ENC-V400	ENC-V500	ENC-V400D	ENC-V500D	ENC-D series
Working range (x*y*z, mm)	300x300x100	400x400x100	500x500x100	400x300x100	500x300x100	X/Y:200~1000
Max load Y/Z	5kg/3kg		10kg/5kg			15kg/15kg
Moving speed (mm/Sec.)	0.1~500/250		0.1~800/500			0.1~1000
Program record volume	4000 points per group, at least 100 group; D series support U disk copy					
Data storage type	CF card				CF Card & PLC	
Program display	Chinese/English LED display					
Motor system	Micro-step precision motor					Servo motor
Position accuracy (mm)	0.02/Axis					0.01/Axis
Round position accuracy (mm)	$\pm 0.02$ /Axis					$\pm 0.01$ /Axis
Operation Mode	PTP & CP					
Interpolation Function	3 Axis					
Edit mode	Teach Pendant / HMI					HMI
I/O Signal port	8 Inputs/Outputs					16 Inputs/Outputs
Power supply	110~240ACV, 50/60Hz					
Working temperature (°C)	-10~40					
Working humidity	20~90% no condensation					
Dimension (mm)	620x580x620	720x680x620	820x780x620	820x580x620	920x580x620	Customization
Net weight (kg)	60	65	70	80	85	/

## Application area:

Home electronic appliances, electronic products, meters, toys, power supply, furniture, LED, communication product, computer keyboard PC, mobile phone, TV, and so on.

# ENC X-Y-Z table screwing machine (Magnet picking up type)

Picking up screw with strong magnet + Special for screw assembling in deep hole

+ Successful screw feeding can reach 99.9% = Perfect performance in your work



## Features:

- 1) Adopt the high quality electric and pneumatic screwdriver especial for automation only, or motor, improve machine stable.
- 2) The front of screwdriver has been installed with electromagnet, it will be power-on to make magnet before the screwdriver bits is going to pick up screw automatically. On the contrary, the electromagnet will be powered off.
- 3) Our X-Y-Z table model is equipped with step motor/servo motor, so the accuracy of round trip can reach  $\pm 0.04\text{mm}$ .
- 4) Big movement range in X, Y, Z direction, The Max. movement range is 500mm. Of course, if your requirement is more than 500mm, then we can custom the model "ENC-D series" for you.
- 5) The X-Y-Z table model is the standard product, so it allows short delivering time and stable function.
- 6) Huge screw feeder, it can hold 2000~10000 pieces screw. So don't require you to supply screws into feeder continually.
- 7) The machine owns an intelligent brain, it can offer many special functions as the following: Quantity statistics (OK amount and NG amount), thread slip detection, floating detection, screw omission detection and so on.

## Reference image:

Two sliding tables type



ENC-M400D



Enlarged view

## Available screw type:

Small size



With washer



Short thread



## NOTE:

- ① The total length must be less than 15mm.
- ② The groove must be cross or slot.
- ③ The texture must be magnetic metal.

## Working steps:

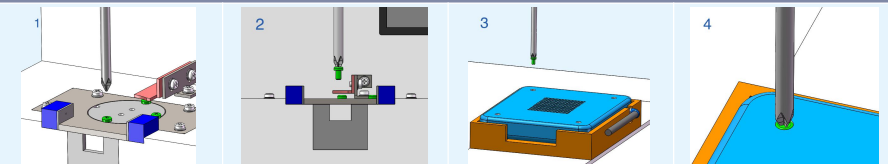

## Specification:

Suffix "D" (Double sliding tables in the Y axis direction)

Item/Model	ENC-M300	ENC-M400	ENC-M500	ENC-M400D	ENC-M500D	ENC-D series
Working range	300x300x100	400x400x100	500x500x100	400x300x100	500x300x100	X/Y:200~1000
Max load Y/Z	5kg/3kg			10kg/5kg		15kg/15kg
Moving speed (mm/Sec.)	0.1~500/250			0.1~800/500		0.1~1000
Program record volume	4000 points per group, at least 100 group; D series support U disk copy					
Data storage type	CF card				CF Card & PLC	
Program display	Chinese/English LED display					
Motor system	Micro-step precision motor					Servo motor
Position accuracy (mm)	0.02/Axis					0.01/Axis
Round position accuracy (mm)	$\pm 0.02$ /Axis					$\pm 0.01$ /Axis
Operation Mode	PTP & CP					
Interpolation Function	3 Axis					
Edit mode	Teach Pendant / HMI					HMI
I/O Signal port	8 Inputs/Outputs					16 Inputs/Outputs
Power supply	110~240ACV, 50/60Hz					
Working temperature (°C)	-10~40					
Working humidity	20~90% no condensation					
Dimension (mm)	620x580x620	720x680x620	820x780x620	820x580x620	920x580x620	Customization
Net weight (kg)	60	65	70	80	85	/

## Application area:

Home electronic appliances, electronic products, meters, toys, power supply, furniture, LED, communication product, computer keyboard PC, mobile phone, TV, and so on.